

QUEEN CREEK MARKETPLACE

SWC ELLSWORTH LOOP RD. & RITTENHOUSE RD.

QUEEN CREEK, AZ

Bath
& Body
Works

DEL TACO

Total Wine
& MORE

COMING SOON!



SHOP SPACE & PADS AVAILABLE

AVAILABILITY

- SHOP SPACE & END CAPS AVAILABLE
- 7 PADS AVAILABLE
- 3,980 SF END CAP WITH PATIO
- 1,768 SF FORMER RESTAURANT

FEATURES

- The project features a tenant mix of over 35 national retailers, including Super-Target, Kohl's, TJ Maxx, Ross and Harkins.
- Traffic Counts

+/- 16,000 CPD ON RITTENHOUSE RD.

+/- 34,000 CPD ON ELLSWORTH LOOP RD.



JOIN

SUPER TARGET

PETSMART

BED BATH &
BEYOND

OLD NAVY

ROSS
DRESS FOR LESS

KOHL'S



TJ-maxx



STRATEGIC

MATT MILINOVICH
602.778.3830
mattm@srgaz.com

JAMES DECREMER
602.778.3840
jamesd@srgaz.com



15169 N. Scottsdale Road #330 Scottsdale, AZ 85254 602.778.3838(p) 602.778.3839(f) www.srgaz.com

2018 Demographics	3 MILE	5 MILE	7 MILE
Estimated Population	39,562	110,142	227,801
Avg Household Income	\$119,710	\$113,176	\$106,023
Daytime Population	11,690	20,980	33,413

SHOP SPACE & PADS AVAILABLE

QUEEN CREEK MARKETPLACE

SWC ELLSWORTH LOOP RD. & RITTENHOUSE RD.

QUEEN CREEK, AZ



Information contained herein is believed to be accurate but is not warranted as to accuracy and may change or be updated without notice. Seller or landlord makes no representation as to the environmental condition of the property and recommends purchaser's or tenant's independent investigation.

#	TENANT	SIZE
Shops A		
1	Alliance Urgent Care	3,905 sf
4	Great Clips	1,000 sf
6	Massage Envy	3,000 sf
8	Sprint	2,175 sf
10	Tips and Toes	1,425 sf
11	The Joint	1,495 sf
13	Pacific Dental	3,950 sf
Shops B		
B101	Torrid	3,000 sf
B102	Pressed for Time Dry Cleaner	1,230 sf
B103	V's Barber Shop	1,000 sf
B104	Available	1,500 sf
B105	360 PT	3,500 sf
B106	Available	2,800 sf

#	TENANT	SIZE
Shops C		
1-2	Maurice's	4,000 sf
3-4	Americas Best Eyewear	3,500 sf
5	Downeast Basics	2,826 sf
6	GNC	1,350 sf
7	Sally Beauty	1,350 sf
8	Bath & Body Works	3,500 sf
9	Justice	4,500 sf
Shops E		
1	Available	3,980 sf
3	Bikes Direct	1,840 sf
4-6	Frazee Paints	4,555 sf
Shops F		
1	Subway	1,845 sf
2	Crumbl Cookies	1,240 sf
3	Data Doctors	1,283 sf

#	TENANT	SIZE
5	Verizon	3,803 sf
7	Available Former Restaurant	1,768 sf
8	Chipotle	2,400 sf
Shops G		
1	Paradise Bakery	4,500 sf
4	2 B Wireless	1,400 sf
5	Yogurt Jungle	1,200 sf
6	Thai Chili	1,600 sf
7	Ahipoke Bowl	1,493 sf
8	Smashburger	2,200 sf
Shops H		
1	Pita Jungle	4,150 sf
3-5	Sauce	3,747 sf
Pads		
A	Olive Garden	7,582 sf
B	Chase Bank	5,608 sf
C	Buffalo Wild Wings	8,000 sf

#	TENANT	SIZE
D	Village Inn	8,000 sf
E	Available	7,000 sf
F	Available	7,000 sf
G	Available	8,000 sf
H	Barrio Queen	8,000 sf
I	In-N-Out	4,000 sf
J	Del Taco	7,000 sf
K	Chick-Fil-A	4,225 sf
L	Barro's	4,000 sf
M	Applebee's	7,000 sf
1	Available	7,153 sf
2	Available	7,763 sf
3	Available	7,475 sf
4	Available	7,475 sf
Major		
Partial G	Available	5,854 sf



STRATEGIC

MATT MILINOVICH
602.778.3830
mattm@srgaz.com

JAMES DECREMER
602.778.3840
jamesd@srgaz.com



SHOPS B

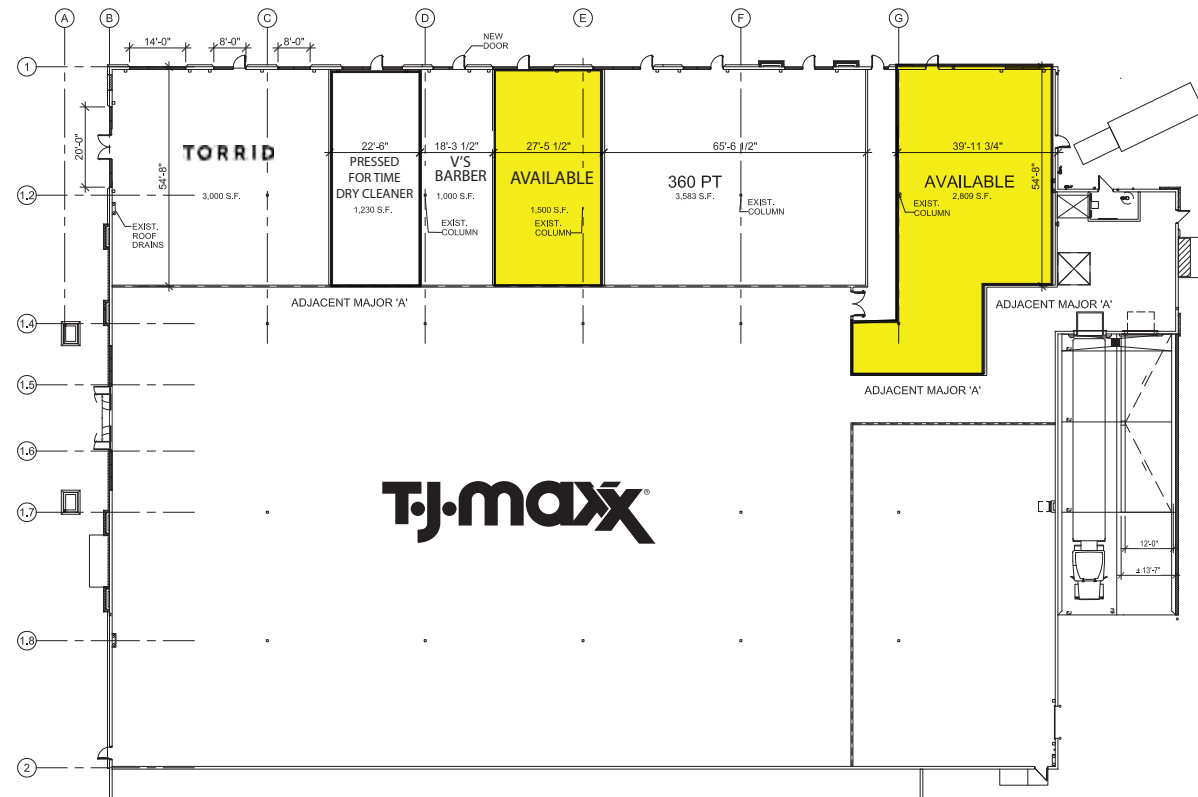

SHOPS C



SHOPS E

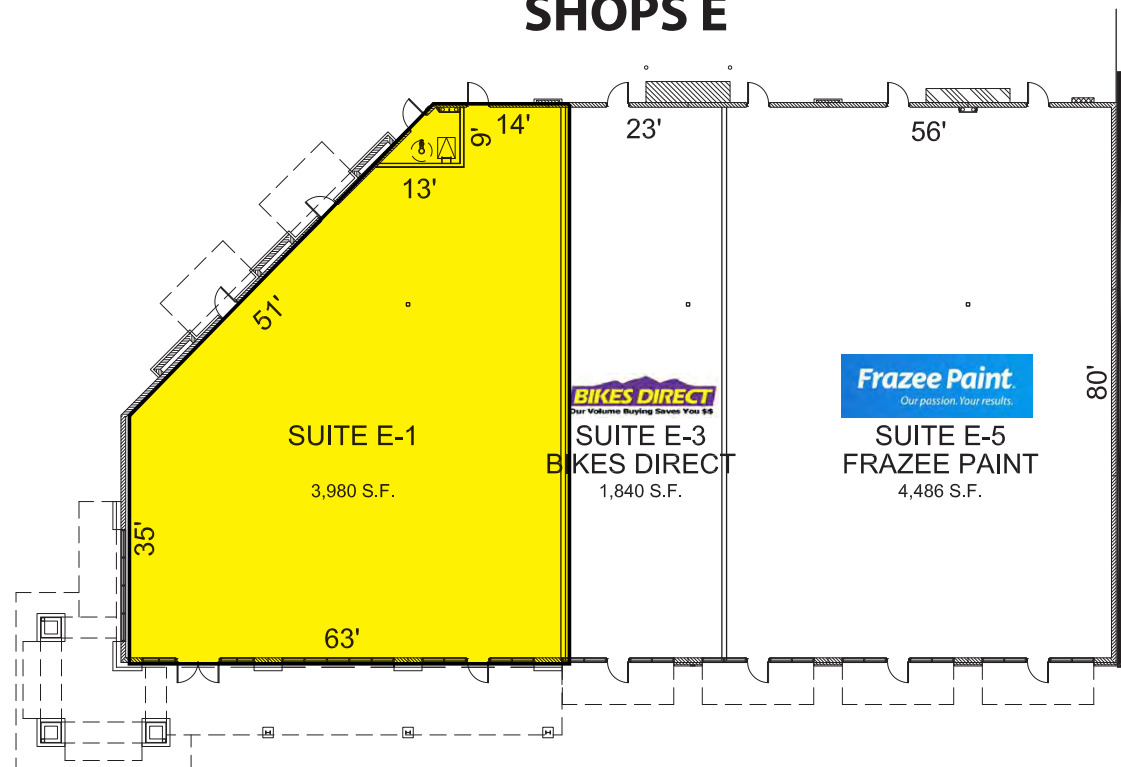

SHOPS F

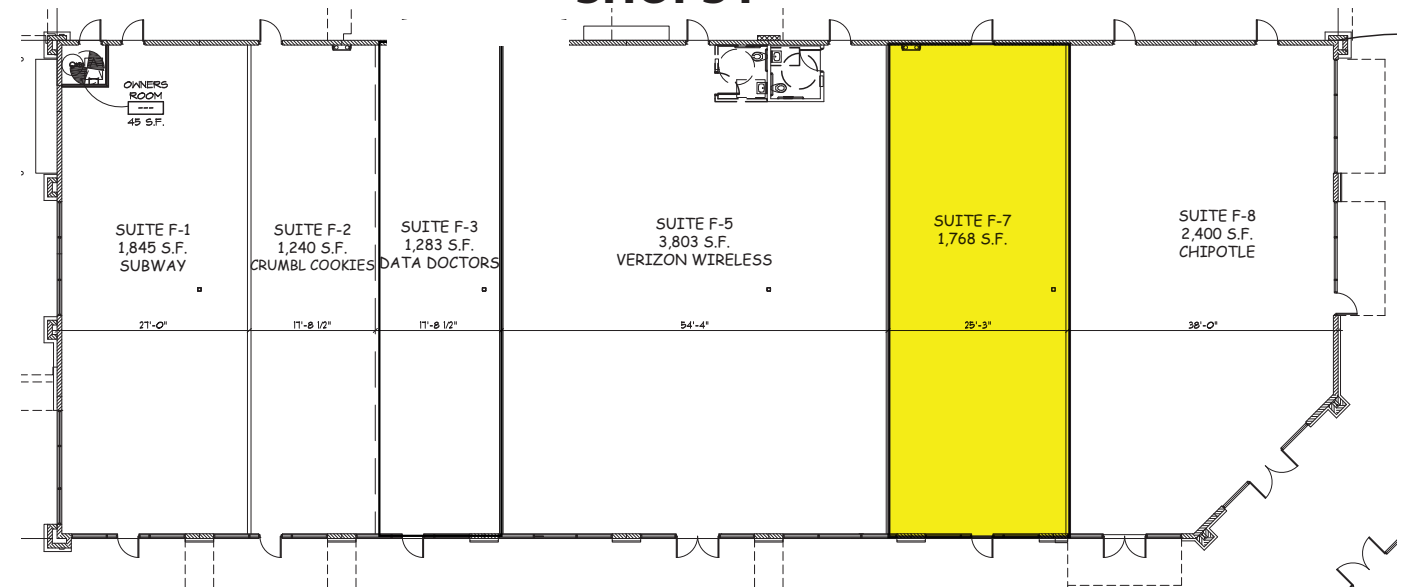

Queen Creek Marketplace Housing Aerial

Warner Rd
Ray Rd
Chandler Blvd
202
Higley Rd
Williams Field Rd
Pecos Rd
Germann Rd
Queen Creek Rd
Ocotillo Rd
Chandler Heights Rd
Riggs Rd
Hunt Hwy

Cooley Station 1,082 Units
Higley Park 611 Units
Lyons Gate 2,164 Units
The Willows 586 Units
Pecos Manor 256 Units
Whitewing at Higley 151 Units
Somerset 286 Units
Stratland Estates 857 Units
Windmill Ranch
Cortina Parcel
La Jara Farms 90 Units
Shea Homes 550 Units
Terravella 60 Units
Light Sky Ranch 113 Units
Barney Farms 1,718 Units
Malone Place 1,129 Units
Ironwood Crossing 2,369 Units
Taylor Ranch 397 Units
Cambria 1 1,100 Units
Castelgate 667 Units
Pecan Ranch 4,968 Units
Home Place 2,176 Units
Laredo Ranch 966 Units
Schnepf & Combs 630 Units
Quail Run Estates 534 Units
Rolling Ridge Estates 60 Units
Skyline Estates 1,017 Units
Bella Vista Farms 12,818 Units
Nevit Farms 1,951 Units
Rancho Bella Vista Phases 1 862 Units
Skyline Ranch 1,633 Units
Morning Sun Farms 1,697 Units
SanTan Shadows 1,909 Units
Borgata 211 Units
Pegasus Airpark 159 Units
Bellerio 178 Units
Orchard Ranch 265 Units
Villages at Queen Creek II 75 Units
La Sencro 283 Units
Stone Creek Estates 164 Units
Meridian 2,310 Units
Villages At Queen Creek 1,789 Units
Hastings Farms 448 Units
The Pecans 258 Units
Sanokai Ranch 80 Units
Terra Ranch 60 Units
Montecena 403 Units
Queen Creek 45 102 Units
Victoria Estates 675 Units
Lucia & Queen Creek 105 Units
Sossaman Estates 2,369 Units
Empower Estates 1,165 Units
Cielo Noche 126 Units
Villagio 135 Units
Queen Creek Station 677 Units
Nauvoo Station 821 Units
Crismon Heights 250 Units
Calatlantic Homes 357 Units
Spur Crossing 722 Units
Barney Park Estates 113 Units
Langley Gateway Estates 113 Units
Ash Creek Estates 144 Units
Ocotillo

Phoenix Mesa Gateway Airport

Bella Via 2,600 Units
Desert Valley 565 Units

Eastmark 17,000 Units

SUBJECT

Legend Ridge 192 units
Eagle Glen 209 Units
Layton Lakes 2,304 Units
Felly Property 200 Units
Marcay Homes 115 Units
Old Stone Ranch 564 Units
Whispering Height 141 Units
Bela Flor 66 Units
Shadow Ridge Falcon Estate 240 Units
Citrus Preserves 240 Units
Evans Ranch 200 Units
Adora Trails 1,800 Units
Cordova 40 Units
Brekewood Estates 47 Units
Goldmine Mountain 114 Units
57 Units

Val Vista Dr
Greenfield Rd
Higley Rd
Power Rd
Ellsworth Rd
Gantz Rd
Combs Rd

STRATEGIC



STRATEGIC

Queen Creek Marketplace Trade Area



EXPANDED PROFILE

2000-2010 Census, 2018 Estimates with 2023 Projections

Calculated using Weighted Block Centroid from Block Groups



Lat/Lon: 33.2561/-111.6388

RF5

21202 South Ellsworth Loop Road

Queen Creek, AZ 85242

3 mi radius

5 mi radius

7 mi radius

Population

Estimated Population (2018)	39,562		110,142		227,801	
Projected Population (2023)	42,802		120,104		249,866	
Census Population (2010)	27,758		84,329		166,850	
Census Population (2000)	4,813		11,292		17,895	
Projected Annual Growth (2018 to 2023)	3,240	1.6%	9,962	1.8%	22,065	1.9%
Historical Annual Growth (2010 to 2018)	11,804	5.3%	25,813	3.8%	60,951	4.6%
Historical Annual Growth (2000 to 2010)	22,945	47.7%	73,037	64.7%	148,955	83.2%
Estimated Population Density (2018)	1,400 psm		1,403 psm		1,480 psm	
Trade Area Size	28.26 sq mi		78.51 sq mi		153.88 sq mi	

Households

Estimated Households (2018)	11,926		34,827		71,952	
Projected Households (2023)	12,509		36,647		75,953	
Census Households (2010)	8,365		26,103		51,843	
Census Households (2000)	1,360		3,332		5,387	
Estimated Households with Children (2018)	5,905	49.5%	16,327	46.9%	33,678	46.8%
Estimated Average Household Size (2018)	3.32		3.15		3.16	

Average Household Income

Estimated Average Household Income (2018)	\$119,710		\$113,176		\$106,023	
Projected Average Household Income (2023)	\$139,905		\$131,599		\$122,394	
Estimated Average Family Income (2018)	\$126,617		\$122,395		\$114,754	

Median Household Income

Estimated Median Household Income (2018)	\$96,402		\$90,429		\$88,714	
Projected Median Household Income (2023)	\$111,454		\$104,478		\$102,241	
Estimated Median Family Income (2018)	\$105,354		\$99,450		\$97,325	

Per Capita Income

Estimated Per Capita Income (2018)	\$36,091		\$35,803		\$33,497	
Projected Per Capita Income (2023)	\$40,892		\$40,170		\$37,213	
Estimated Per Capita Income 5 Year Growth	\$4,801	13.3%	\$4,367	12.2%	\$3,716	11.1%
Estimated Average Household Net Worth (2018)	\$1,381,637		\$1,225,461		\$1,158,375	

Daytime Demos (2018)

Total Businesses	884		2,036		3,597	
Total Employees	11,690		20,980		33,413	
Company Headquarter Businesses	-	-	2	0.1%	4	0.1%
Company Headquarter Employees	4	-	198	0.9%	450	1.3%
Employee Population per Business	13.2		10.3		9.3	
Residential Population per Business	44.7		54.1		63.3	

This report was produced using data from private and government sources deemed to be reliable. The information herein is provided without representation or warranty.

EXPANDED PROFILE

2000-2010 Census, 2018 Estimates with 2023 Projections

Calculated using Weighted Block Centroid from Block Groups



Lat/Lon: 33.2561/-111.6388

RF5

21202 South Ellsworth Loop Road

Queen Creek, AZ 85242

3 mi radius

5 mi radius

7 mi radius

Race & Ethnicity

White (2018)	31,102	78.6%	86,821	78.8%	177,988	78.1%
Black or African American (2018)	1,850	4.7%	5,187	4.7%	11,070	4.9%
American Indian or Alaska Native (2018)	306	0.8%	984	0.9%	2,135	0.9%
Asian (2018)	1,605	4.1%	4,729	4.3%	10,771	4.7%
Hawaiian or Pacific Islander (2018)	74	0.2%	220	0.2%	462	0.2%
Other Race (2018)	3,057	7.7%	7,764	7.0%	15,758	6.9%
Two or More Races (2018)	1,567	4.0%	4,437	4.0%	9,617	4.2%
Not Hispanic or Latino Population (2018)	31,529	79.7%	88,122	80.0%	181,233	79.6%
Hispanic or Latino Population (2018)	8,033	20.3%	22,020	20.0%	46,568	20.4%
Not Hispanic or Latino Population (2023)	33,349	77.9%	93,979	78.2%	194,403	77.8%
Hispanic or Latino Population (2023)	9,453	22.1%	26,125	21.8%	55,463	22.2%
Not Hispanic or Latino Population (2010)	22,931	82.6%	69,414	82.3%	135,898	81.4%
Hispanic or Latino Population (2010)	4,827	17.4%	14,916	17.7%	30,952	18.6%
Not Hispanic or Latino Population (2000)	3,464	72.0%	8,481	75.1%	13,762	76.9%
Hispanic or Latino Population (2000)	1,350	28.0%	2,811	24.9%	4,133	23.1%
Projected Hispanic Annual Growth (2018 to 2023)	1,420	3.5%	4,105	3.7%	8,895	3.8%
Historic Hispanic Annual Growth (2000 to 2018)	6,684	27.5%	19,209	38.0%	42,435	57.0%

Age Distribution (2018)

Age Under 5	3,266	8.3%	8,927	8.1%	18,691	8.2%
Age 5 to 9 Years	3,604	9.1%	9,595	8.7%	19,705	8.7%
Age 10 to 14 Years	3,474	8.8%	9,342	8.5%	19,084	8.4%
Age 15 to 19 Years	2,717	6.9%	7,513	6.8%	15,162	6.7%
Age 20 to 24 Years	1,847	4.7%	5,514	5.0%	11,766	5.2%
Age 25 to 29 Years	2,624	6.6%	7,219	6.6%	16,022	7.0%
Age 30 to 34 Years	3,266	8.3%	8,675	7.9%	18,748	8.2%
Age 35 to 39 Years	3,347	8.5%	9,125	8.3%	18,869	8.3%
Age 40 to 44 Years	2,749	6.9%	7,593	6.9%	15,810	6.9%
Age 45 to 49 Years	2,448	6.2%	6,600	6.0%	13,754	6.0%
Age 50 to 54 Years	2,121	5.4%	5,701	5.2%	11,812	5.2%
Age 55 to 59 Years	2,028	5.1%	5,639	5.1%	11,534	5.1%
Age 60 to 64 Years	1,899	4.8%	5,464	5.0%	10,750	4.7%
Age 65 to 74 Years	2,769	7.0%	8,629	7.8%	16,734	7.3%
Age 75 to 84 Years	1,061	2.7%	3,536	3.2%	7,225	3.2%
Age 85 Years or Over	341	0.9%	1,070	1.0%	2,133	0.9%
Median Age	32.9		33.7		33.1	

Gender Age Distribution (2018)

Female Population	19,788	50.0%	55,481	50.4%	114,887	50.4%
Age 0 to 19 Years	6,233	31.5%	17,125	30.9%	35,160	30.6%
Age 20 to 64 Years	11,416	57.7%	31,465	56.7%	66,143	57.6%
Age 65 Years or Over	2,139	10.8%	6,890	12.4%	13,584	11.8%
Female Median Age	33.2		34.0		33.4	
Male Population	19,774	50.0%	54,661	49.6%	112,913	49.6%
Age 0 to 19 Years	6,829	34.5%	18,252	33.4%	37,482	33.2%
Age 20 to 64 Years	10,914	55.2%	30,065	55.0%	62,924	55.7%
Age 65 Years or Over	2,031	10.3%	6,344	11.6%	12,507	11.1%
Male Median Age	32.6		33.4		32.7	

This report was produced using data from private and government sources deemed to be reliable. The information herein is provided without representation or warranty.

EXPANDED PROFILE

2000-2010 Census, 2018 Estimates with 2023 Projections

Calculated using Weighted Block Centroid from Block Groups



Lat/Lon: 33.2561/-111.6388

RF5

21202 South Ellsworth Loop Road

Queen Creek, AZ 85242

Household Income Distribution (2018)

	3 mi radius		5 mi radius		7 mi radius	
HH Income \$200,000 or More	1,516	12.7%	3,567	10.2%	6,685	9.3%
HH Income \$150,000 to \$199,999	1,505	12.6%	3,811	10.9%	7,367	10.2%
HH Income \$100,000 to \$149,999	2,586	21.7%	7,873	22.6%	15,815	22.0%
HH Income \$75,000 to \$99,999	1,676	14.1%	5,048	14.5%	10,771	15.0%
HH Income \$50,000 to \$74,999	1,715	14.4%	5,915	17.0%	13,089	18.2%
HH Income \$35,000 to \$49,999	1,086	9.1%	3,461	9.9%	7,714	10.7%
HH Income \$25,000 to \$34,999	641	5.4%	1,916	5.5%	3,861	5.4%
HH Income \$15,000 to \$24,999	548	4.6%	1,577	4.5%	3,092	4.3%
HH Income Under \$15,000	653	5.5%	1,660	4.8%	3,558	4.9%
HH Income \$35,000 or More	10,084	84.6%	29,674	85.2%	61,441	85.4%
HH Income \$75,000 or More	7,283	61.1%	20,298	58.3%	40,638	56.5%

Housing (2018)

Total Housing Units	12,445		36,673		75,369	
Housing Units Occupied	11,926	95.8%	34,827	95.0%	71,952	95.5%
Housing Units Owner-Occupied	10,180	85.4%	28,437	81.7%	59,241	82.3%
Housing Units, Renter-Occupied	1,746	14.6%	6,390	18.3%	12,711	17.7%
Housing Units, Vacant	519	4.2%	1,846	5.0%	3,418	4.5%

Marital Status (2018)

Never Married	6,667	22.8%	21,710	26.4%	47,622	28.0%
Currently Married	18,412	63.0%	47,791	58.1%	94,643	55.6%
Separated	804	2.8%	2,783	3.4%	5,927	3.5%
Widowed	854	2.9%	2,649	3.2%	5,552	3.3%
Divorced	2,480	8.5%	7,345	8.9%	16,576	9.7%

Household Type (2018)

Population Family	36,745	92.9%	100,752	91.5%	207,891	91.3%
Population Non-Family	2,801	7.1%	9,048	8.2%	19,545	8.6%
Population Group Quarters	16	-	343	0.3%	365	0.2%
Family Households	9,892	82.9%	28,197	81.0%	57,846	80.4%
Non-Family Households	2,034	17.1%	6,630	19.0%	14,106	19.6%
Married Couple with Children	4,728	25.7%	12,611	26.4%	25,856	27.3%
Average Family Household Size	3.7		3.6		3.6	

Household Size (2018)

1 Person Households	1,453	12.2%	4,813	13.8%	10,030	13.9%
2 Person Households	3,231	27.1%	10,465	30.0%	21,261	29.5%
3 Person Households	2,050	17.2%	5,839	16.8%	12,384	17.2%
4 Person Households	2,514	21.1%	6,793	19.5%	14,187	19.7%
5 Person Households	1,439	12.1%	3,874	11.1%	8,015	11.1%
6 or More Person Households	1,238	10.4%	3,043	8.7%	6,076	8.4%

Household Vehicles (2018)

Households with 0 Vehicles Available	149	1.3%	548	1.6%	1,296	1.8%
Households with 1 Vehicles Available	2,724	22.8%	8,428	24.2%	17,130	23.8%
Households with 2 or More Vehicles Available	9,053	75.9%	25,851	74.2%	53,525	74.4%
Total Vehicles Available	25,341		71,973		148,647	
Average Vehicles Per Household	2.1		2.1		2.1	

This report was produced using data from private and government sources deemed to be reliable. The information herein is provided without representation or warranty.

EXPANDED PROFILE

2000-2010 Census, 2018 Estimates with 2023 Projections

Calculated using Weighted Block Centroid from Block Groups



Lat/Lon: 33.2561/-111.6388

RF5

21202 South Ellsworth Loop Road

Queen Creek, AZ 85242

3 mi radius

5 mi radius

7 mi radius

Labor Force (2018)

Estimated Labor Population Age 16 Years or Over	28,608		80,639		166,908	
Estimated Civilian Employed	18,968	66.3%	52,679	65.3%	110,708	66.3%
Estimated Civilian Unemployed	360	1.3%	1,524	1.9%	3,518	2.1%
Estimated in Armed Forces	1	-	66	0.1%	172	0.1%
Estimated Not in Labor Force	9,278	32.4%	26,369	32.7%	52,511	31.5%
Unemployment Rate	1.3%		1.9%		2.1%	

Occupation (2015)

Occupation: Population Age 16 Years or Over	19,226		52,560		111,045	
Management, Business, Financial Operations	4,129	21.5%	10,083	19.2%	20,635	18.6%
Professional, Related	5,400	28.1%	13,757	26.2%	28,129	25.3%
Service	2,762	14.4%	8,824	16.8%	19,314	17.4%
Sales, Office	4,356	22.7%	12,594	24.0%	27,523	24.8%
Farming, Fishing, Forestry	38	0.2%	107	0.2%	226	0.2%
Construct, Extraction, Maintenance	1,280	6.7%	3,435	6.5%	7,154	6.4%
Production, Transport Material Moving	1,262	6.6%	3,760	7.2%	8,064	7.3%
White Collar Workers	13,884	72.2%	36,435	69.3%	76,287	68.7%
Blue Collar Workers	5,342	27.8%	16,126	30.7%	34,757	31.3%

Consumer Expenditure (2018)

Total Household Expenditure	\$959 M		\$2.68 B		\$5.28 B	
Total Non-Retail Expenditure	\$505 M	52.7%	\$1.41 B	52.4%	\$2.76 B	52.3%
Total Retail Expenditure	\$454 M	47.3%	\$1.28 B	47.6%	\$2.52 B	47.7%
Apparel	\$34.1 M	3.6%	\$94.9 M	3.5%	\$187 M	3.5%
Contributions	\$47.7 M	5.0%	\$129 M	4.8%	\$250 M	4.7%
Education	\$40.5 M	4.2%	\$110 M	4.1%	\$214 M	4.0%
Entertainment	\$54.6 M	5.7%	\$153 M	5.7%	\$300 M	5.7%
Food and Beverages	\$136 M	14.2%	\$385 M	14.3%	\$759 M	14.4%
Furnishings and Equipment	\$34.3 M	3.6%	\$95.6 M	3.6%	\$188 M	3.6%
Gifts	\$26.0 M	2.7%	\$71.5 M	2.7%	\$139 M	2.6%
Health Care	\$71.1 M	7.4%	\$202 M	7.5%	\$399 M	7.6%
Household Operations	\$30.2 M	3.1%	\$82.8 M	3.1%	\$162 M	3.1%
Miscellaneous Expenses	\$13.5 M	1.4%	\$38.3 M	1.4%	\$75.4 M	1.4%
Personal Care	\$12.3 M	1.3%	\$34.6 M	1.3%	\$68.2 M	1.3%
Personal Insurance	\$7.90 M	0.8%	\$21.6 M	0.8%	\$42.1 M	0.8%
Reading	\$2.12 M	0.2%	\$5.94 M	0.2%	\$11.7 M	0.2%
Shelter	\$199 M	20.7%	\$555 M	20.7%	\$1.09 B	20.6%
Tobacco	\$4.99 M	0.5%	\$14.4 M	0.5%	\$28.6 M	0.5%
Transportation	\$177 M	18.5%	\$501 M	18.7%	\$990 M	18.7%
Utilities	\$67.5 M	7.0%	\$191 M	7.1%	\$378 M	7.2%

Educational Attainment (2018)

Adult Population Age 25 Years or Over	24,653		69,251		143,392	
Elementary (Grade Level 0 to 8)	447	1.8%	1,558	2.3%	3,361	2.3%
Some High School (Grade Level 9 to 11)	744	3.0%	2,442	3.5%	5,315	3.7%
High School Graduate	4,572	18.5%	12,692	18.3%	28,379	19.8%
Some College	6,724	27.3%	19,042	27.5%	39,247	27.4%
Associate Degree Only	2,609	10.6%	7,664	11.1%	15,608	10.9%
Bachelor Degree Only	6,064	24.6%	16,984	24.5%	34,422	24.0%
Graduate Degree	3,494	14.2%	8,869	12.8%	17,060	11.9%

This report was produced using data from private and government sources deemed to be reliable. The information herein is provided without representation or warranty.

EXPANDED PROFILE

2000-2010 Census, 2018 Estimates with 2023 Projections

Calculated using Weighted Block Centroid from Block Groups



Lat/Lon: 33.2561/-111.6388

RF5

21202 South Ellsworth Loop Road

Queen Creek, AZ 85242

3 mi radius

5 mi radius

7 mi radius

Units In Structure (2015)

1 Detached Unit	11,139	133.2	30,976	118.7	64,599	124.6
1 Attached Unit	140	1.7%	644	2.5%	1,545	3.0%
2 to 4 Units	58	0.7%	201	0.8%	413	0.8%
5 to 9 Units	302	3.6%	486	1.9%	735	1.4%
10 to 19 Units	199	2.4%	543	2.1%	909	1.8%
20 to 49 Units	71	0.9%	196	0.8%	400	0.8%
50 or More Units	167	2.0%	389	1.5%	766	1.5%
Mobile Home or Trailer	207	2.5%	1,292	5.0%	2,720	5.2%
Other Structure	-	-	17	0.1%	54	0.1%

Homes Built By Year (2015)

Homes Built 2010 or later	1,065	12.7%	2,424	9.3%	4,263	8.2%
Homes Built 2000 to 2009	7,690	91.9%	21,889	83.9%	45,262	87.3%
Homes Built 1990 to 1999	898	10.7%	2,966	11.4%	5,966	11.5%
Homes Built 1980 to 1989	694	8.3%	1,651	6.3%	3,067	5.9%
Homes Built 1970 to 1979	502	6.0%	1,524	5.8%	2,853	5.5%
Homes Built 1960 to 1969	156	1.9%	516	2.0%	900	1.7%
Homes Built 1950 to 1959	77	0.9%	371	1.4%	605	1.2%
Homes Built Before 1949	94	1.1%	294	1.1%	487	0.9%

Home Values (2015)

Home Values \$1,000,000 or More	61	0.9%	158	0.8%	290	0.7%
Home Values \$500,000 to \$999,999	947	14.1%	2,182	10.7%	4,244	10.5%
Home Values \$400,000 to \$499,999	1,034	15.4%	2,393	11.8%	4,318	10.6%
Home Values \$300,000 to \$399,999	2,368	35.3%	5,589	27.5%	10,921	26.9%
Home Values \$200,000 to \$299,999	3,604	53.6%	9,496	46.8%	19,159	47.2%
Home Values \$150,000 to \$199,999	1,567	23.3%	4,914	24.2%	11,874	29.3%
Home Values \$100,000 to \$149,999	536	8.0%	2,170	10.7%	5,336	13.2%
Home Values \$70,000 to \$99,999	74	1.1%	402	2.0%	1,055	2.6%
Home Values \$50,000 to \$69,999	48	0.7%	163	0.8%	464	1.1%
Home Values \$25,000 to \$49,999	40	0.6%	226	1.1%	456	1.1%
Home Values Under \$25,000	197	2.9%	566	2.8%	1,249	3.1%
Owner-Occupied Median Home Value	\$286,071		\$268,081		\$251,477	
Renter-Occupied Median Rent	\$1,140		\$1,048		\$1,060	

Transportation To Work (2015)

Drive to Work Alone	14,883	77.3%	38,702	76.6%	79,215	77.2%
Drive to Work in Carpool	1,922	10.0%	5,175	10.2%	10,949	10.7%
Travel to Work by Public Transportation	141	0.7%	347	0.7%	712	0.7%
Drive to Work on Motorcycle	80	0.4%	194	0.4%	423	0.4%
Walk or Bicycle to Work	239	1.2%	759	1.5%	1,417	1.4%
Other Means	151	0.8%	407	0.8%	971	0.9%
Work at Home	1,835	9.5%	4,939	9.8%	8,953	8.7%

Travel Time (2015)

Travel to Work in 14 Minutes or Less	2,682	15.4%	7,094	15.6%	14,857	15.9%
Travel to Work in 15 to 29 Minutes	5,146	29.5%	14,356	31.5%	30,345	32.4%
Travel to Work in 30 to 59 Minutes	7,558	43.4%	20,129	44.2%	43,531	46.5%
Travel to Work in 60 Minutes or More	1,953	11.2%	5,855	12.8%	12,736	13.6%
Average Minutes Travel to Work	30.0		30.1		30.3	

This report was produced using data from private and government sources deemed to be reliable. The information herein is provided without representation or warranty.